

MOBILE COFFEE KIOSK

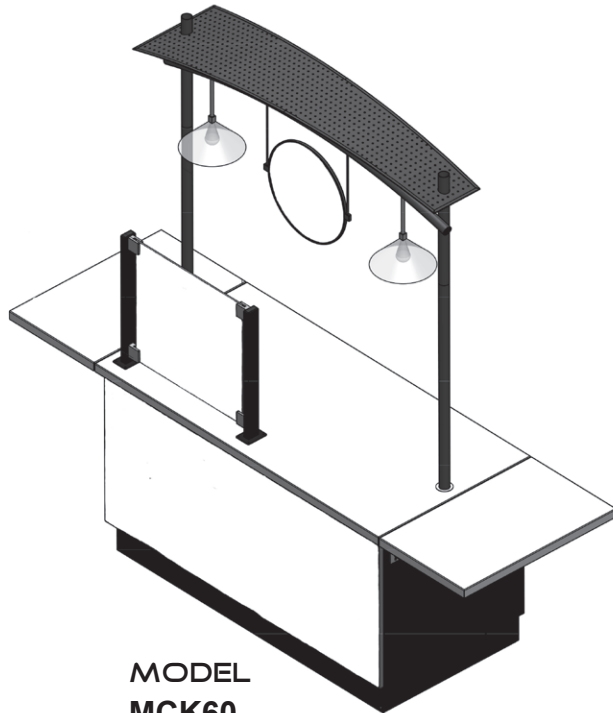

**MODEL
MCK60**

Shown with optional stainless steel drop leaves, decorative overstructure, sign and pendant lights.

- ▶ Durable welded stainless steel square tube frame construction
- ▶ Top-mounted panel conceals coffee brewing equipment
- ▶ Available decorative overstructure with merchandising sign and pendant lights
- ▶ Endless choice of exterior front décor panels with black end panels
- ▶ Interior storage compartments with removable shelves
- ▶ Sturdy 18" stainless steel drop leaves (optional) with grommet hole accommodate payment register or other equipment
- ▶ Heavy-duty 5" diameter casters with rounded cushion-tread for quiet, easy movement

Item # _____ Quantity _____
Project _____

*Merchandise Profitable Coffee
Drinks In High Traffic Locations*

OPTIONS & ACCESSORIES

Countertop

- Stainless steel (std.)
- Solid surface
- Quartz

Stainless Steel Drop Leaves

- 18" one end with grommet hole
- 18" both ends (1 with hole)

Exterior Panels

- Plastic decorative laminate (std)
- Stainless steel
- High resolution vinyl image

Decorative Overstructure

- Black powdercoat (std.)
- Stainless steel
- With pendant lights
- Custom color powdercoat
- With 16" dia. sign

Electrical

- Duplex outlet (flush)
- 120 VAC service for POS & lights
- Single point electrical service for pendant lights, coffee brewing equipment, cash register, etc. (consult factory)
- 208 VAC 1-phase or 3-phase service for coffee brewing equipment*

*(Make/model/voltage _____)

Casters/Legs

- 5" swivel (std.)
- 6" adjustable legs

Bottom Kickplate

- Black powdercoat finish (std.)
- Stainless steel

Other Options/Accessories

- Insulated compartment for whipped cream
- Stainless steel 8" fold-down work ledge (operator side)
- Hinged doors
- Interior pan slides
- Swing-out dropleaf supports
- Cup dispensers (___ qty.)
- Countertop grommet holes
- Poly cutting board with fold-down brackets
- Drip trough
- Door lock
- Custom length (____")

Specifications (general)

Shall be Multiteria **Model MCK60** and shall be of welded stainless steel construction, with decorative laminate exterior sides and structural stainless steel square tubular construction. Body frame shall be welded and polished, and shall include channel framework at ends and front to accept décor panels. Counter top shall be made of 14-gauge 304 stainless steel with 1½" top turnaround and stainless steel support channels. Interior compartments shall include a removable stainless steel undershelves, with 3" space from the counter front to allow space to run plumbing and electrical connections. Interior work panel shall accommodate optional cup dispensers and/or optional insulated compartment for whipped cream storage. A 22½" x 22" front panel shall be mounted to the top for concealment of coffee making equipment or merchandising/menu placement. Exterior front shall include black epoxy powder coated kickplates mounted to the counter frame. Removable exterior décor panels shall be ½" thick laminated on front, edges, and back. End panels shall be removable (except when ordered with electrical outlets or drop leaves) without the use of tools.

MOBILE COFFEE KIOSK

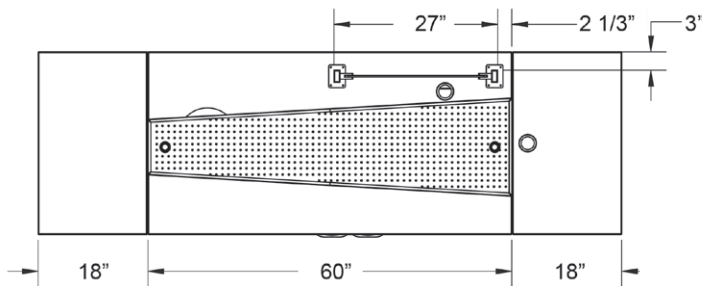

Plan View ▲

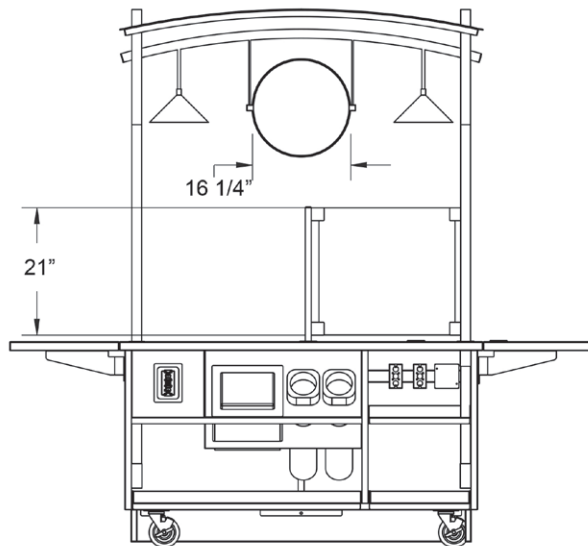

Rear View ▲

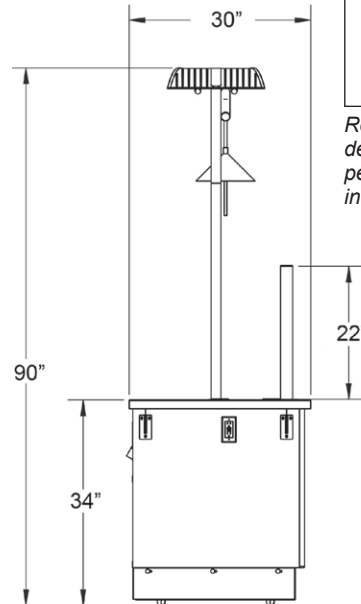

End View ▲

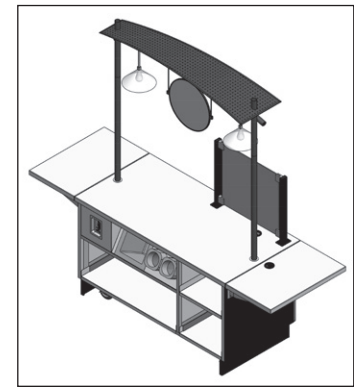

Rear view shown with optional decorative overstructure and pendant lights, cup dispensers and insulated storage compartment.



Optional hinged swing-out drop leaf supports offer additional front surface and concealment.

Model Detail

Model	Overall Size			Interior Compartments			Top W x L	Leaves Dn		Casters		Ship Wt. Lbs.
	W	D	H ¹	W	D	H		W	D	Type	Dia.	
MCK60	60"	30"	56"	Lower Left 35½" 23½" 9" Upper Right 15" 23½" 11" Upper Right 15" 23½" 13"	30" x 60"	72"	30"	2 Ea. Swivel/Brake 2 Ea. Fixed	5"	515		

¹ With overhead frame O.A. height is 90".

Front & End Décor Panels:

All millwork panels shall have standard plastic laminate on front and white laminate on hidden interior side. Panels shall be removable for service access. Panels shall have removable tray rail brackets for convenient front access for plumbing and electrical connections or service. Décor end panels shall be removable without use of tools.

Decorative Overstructure (optional)

Shall include stainless steel 1-5/8" tubing uprights and curved cross-members with black (standard) epoxy powder coat finish. Decorative curved canopy shall be 18-gauge perforated stainless steel with epoxy powder coat finish. Optional pendant lights feature decorative conical clear glass shades and decorative lamps. Overstructure top shall be removable to fit through doorways.

Casters

Unit shall have four each extra-load plate type casters, two fixed and two swivel with brake, mounted to the counter frame. Caster wheels shall be 5" diameter with non-marking, rounded cushion tread.